

SPECIFICATION

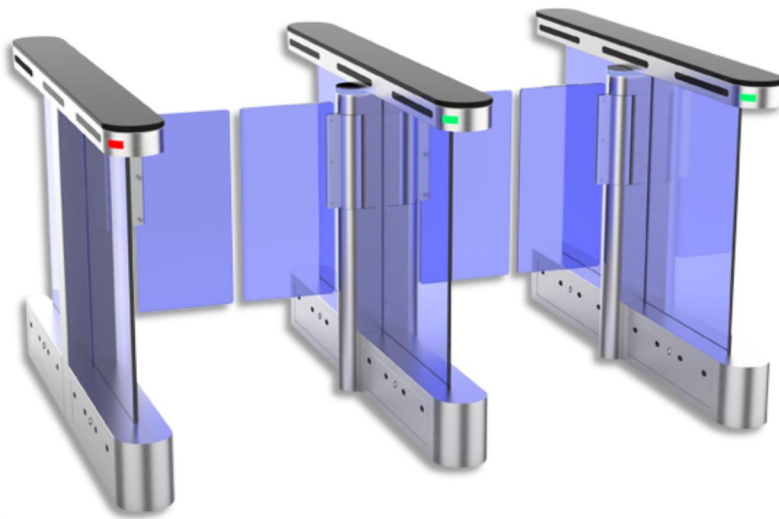

SWB320 MAG SWING BARRIER



SWB320 MAG SWING BARRIER

Description

MAG SWB320 is the slimmest of the pedestrian gate series. The minimalistic design with transparent acrylic seamlessly blend in any premium building interior to create a welcoming atmosphere while still maintaining security. High performance servo motor offers higher pass through rate to avoid congestion during peak hours. MAG SWB320 also offers wide lane clearance to allow comfortably passing through with luggages.

MAG SWB320 is suitable for indoor only. It is an optimized solution for high pedestrian traffic with stylish design to elevate your building entrance.

Features

✓ **Elegant design**

Slim round-ended design, built with premium stainless steel and acrylic glass accentuated with intuitive RGB LED indicator to elevate your building entrance and impress your visitors.

✓ **Minimum maintenance**

Advanced servo controlled motor optimize rotation speed to minimize maintenance and achieve lowest operation noise.

✓ **Double safety**

Reliable infrared sensor will detect obstacle and prevent flap from closing. Smart algorithm will detect small force obstructing motor motion and auto reverse, minimizing risk of injury.

✓ **Flexible operation mode**

Support multiple access memory, IR sensor-triggered auto-opening, single or bi-directional access.

✓ **Emergency evacuation**

SWB320 will automatically open during power failure, or can be configured to open immediately when fire alarm signal is received.

✓ **Illegal access alarm**

Reliable IR sensor will detect illegal access and trigger buzzer during tailgating attempt, intruder coming in at opposite direction and illegal entry without valid access signal

SPECIFICATION

Special effect

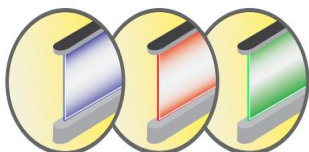

Blue light to indicate standby.

Red light to indicate alarm (invalid entry).

Green light to indicate valid entry.

Technical Parameter

Description	Parameters
Body Material	Acrylic glass, SS304 stainless steel 2mm ± 0.2mm
Door Dimension (Single Panel)	275mm(W) x 560mm(H) (Standard dimension) 280mm(W) x 1150mm(H) (Customized dimension) 490mm(W) x 560mm(H) (Customized dimension)
Door opening / closing speed	Programmable, 0.7s minimum
Optimal flow rate	30 people per minute
Power supply	AC220/110V±10%, 50/60Hz
Power Consumption	<30W (Standby), <100W (Operational)
Motor	DC Brushless Servo Motor, 24V
Input Connection	Dry contact pulse > 500ms
Working environment	Indoor only
Working Temperature	-15℃ - 60℃
Relative Humidity	≤ 90%, non-condensing
Passage Width (suggested)	Up to 1.2m
Gate Door Material	Acrylic, 12.0 ± 0.6 mm thickness
IP Rating	IP 44
MTBF	5 million cycles

Dimension Standard Lane

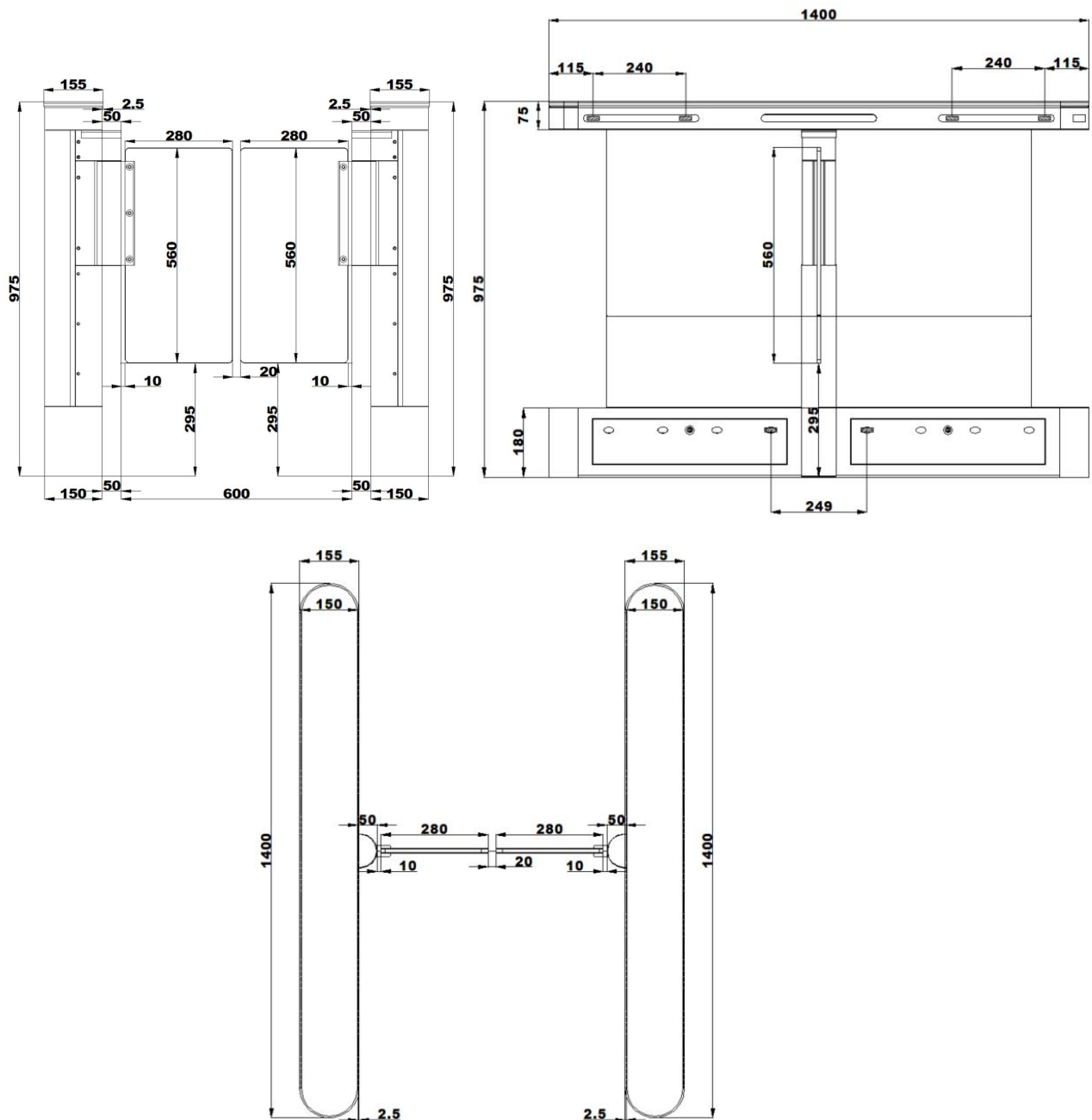

SPECIFICATION

High Panel

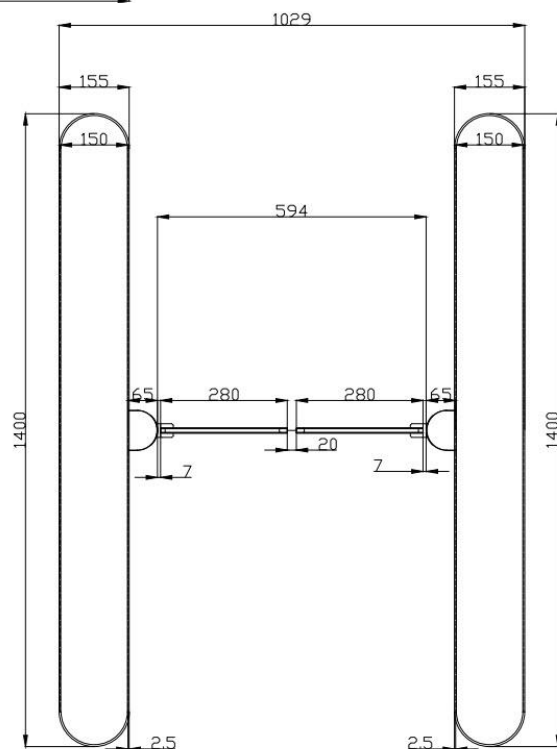
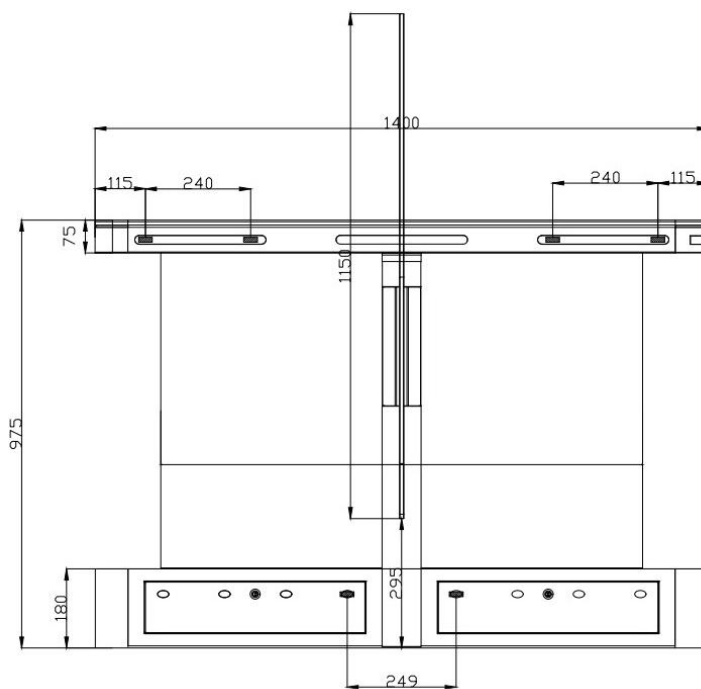
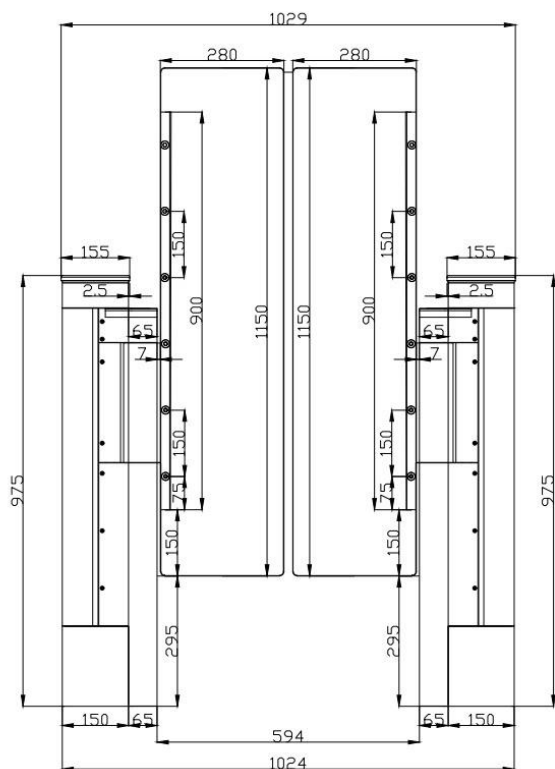

***Product performances is based on testing in a controlled environment.**

Your result may vary due to several external and environment factors.

© COPYRIGHT 2024. This documentation served as a reference only. It is subject to change without further notice. All the diagrams and information in this documentation may not be duplicated or modified in any form without the written approval from the management.