

SPECIFICATION



AR888ULS SOYAL QR Code Reader



AR888ULS - SOYAL QR Code Reader

Technical Parameters

Communication interface	WG 26/ 34 / QR Code
Output interface	Wiegand, RS485
User capacity	No
Supported frequency	Dual Band 125kHz & 13.56Mhz (EM & Mifare, DESFire)
QR reading distance	5 - 10cm (adjust according to QR code size)
EM reading distance	5 - 15cm
Mifare, DESFire	2 - 5cm
Relay Output	No
Relay Input	No
Scan rate	60 fps
Indicator	Dual-Color LED frame indicator -Green blinking (Standby Mode) -Green Static (Valid Access) -Red Static (Invalid Access)
Buzzer	Yes
Power voltage consumption	12VDC; <1W
Operating Temperature	-20°C to 65°C
Operating humidity	20% - 90% (Non Condensing)
Dimension	88mm(H) x 86mm(W) x (9mm(D)+37.5mm(D))
Housing	-IP65 Weather proof (Surface) -Tempered Glass Panel+ABS (Fire-proof level: 94V0)
Color	Bright black

Scanning Distance and Supported QR Format

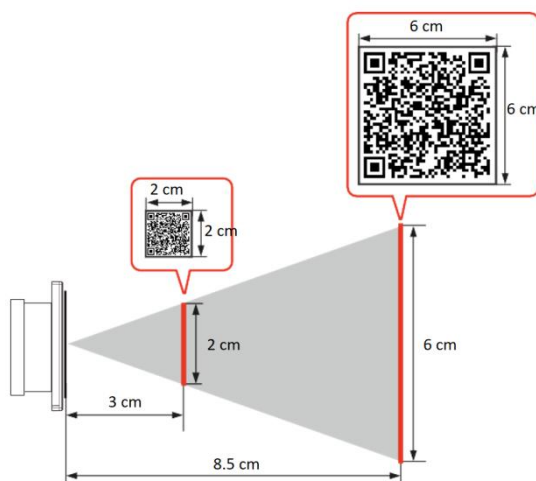

The standard firmware supports QR Code format as below and other QR Code format can be supported by customized firmware.

- QRCo08A12345678
- QRCo10A1234567890
- QRCo14A12345678901234
- QRCo55W1234556789
- QRCo08H33CDAB88

Type of Bar Code	Density	Min. distance	Max. distance
Code 39	0.125 mm (5 mils)	4.0 cm	9.0 cm
	0.375 mm (15 mils)	4.0 cm	25.0 cm
UPC/EAN	0.375 mm (15 mils)	4.0 cm	25.0 cm
Code93	0.254 mm (10 mils)	4.0 cm	21.0 cm

Dimension

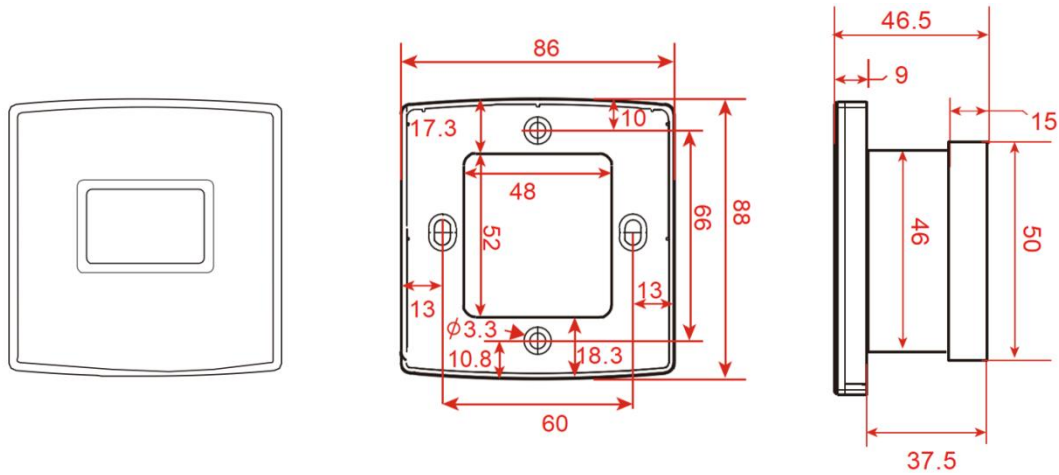

Installation

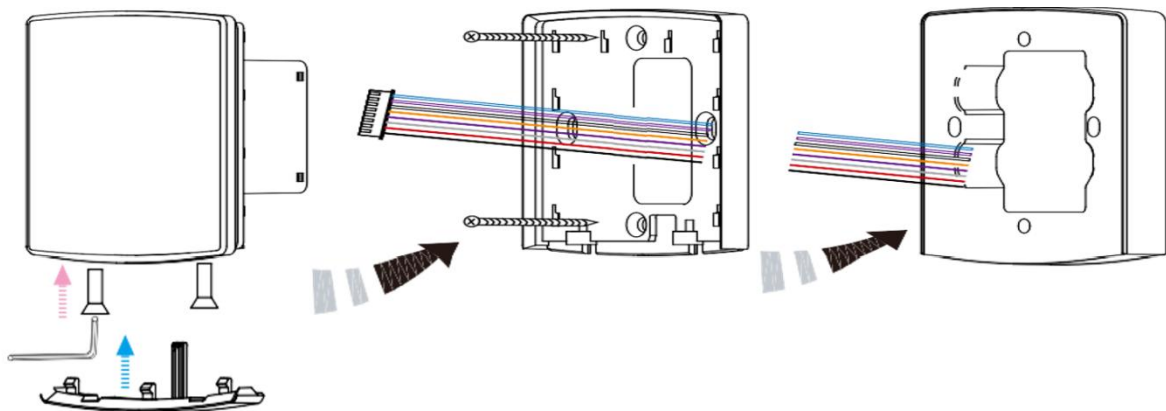

***Product performances is based on testing in a controlled environment. Your result may vary due to several external and environment factors.**

© COPYRIGHT 2025. This documentation served as a reference only. It is subject to change without further notice. All the diagrams and information in this documentation may not be duplicated or modified in any form without the written approval from the management.

